

D

C

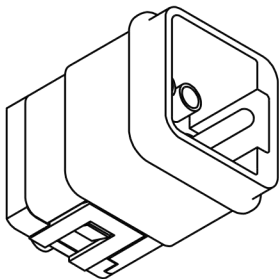
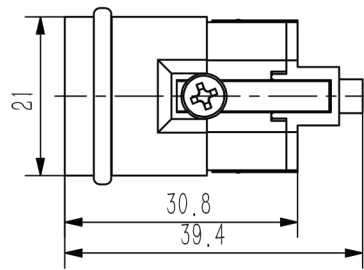
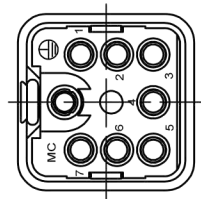

技术参数:

插芯:

- 插针数: 7+PE
- 额定电流: 10A
- 额定电压: 400V
- 额定脉冲电压: 6kV
- 污染等级: 3
- 依据UL/CSA的额定电压: 600V
- 绝缘阻抗: $>10^{10}\Omega$
- 材料: 聚碳酸酯
- 颜色: RAL 7032 (浅灰色)
- 温度范围: $-40^{\circ}\text{C} - +125^{\circ}\text{C}$
- 依据UL 94的阻燃等级: V0
- 可插拔次数: >500

插针:

- 接线方式: 冷压连接
- 材料: 铜合金
- 表面处理:
 - 镀银
 - 镀金
- 接触电阻: $<3\text{m}\Omega$
- 线径范围:
 - 冷压连接: $0.14-2.5\text{mm}^2(26-14\text{ AWG})$
 - PE连接: $2.5\text{mm}^2(14\text{ AWG})$

外壳:

- 材料:
 - 塑料外壳: 聚碳酸酯
 - 金属外壳: 压铸锌
 - 依据UL 94的阻燃等级:
 - 塑料外壳: V0
 - 防护等级, 联锁状态, IEC 60529:
 - 塑料外壳: IP67
 - 金属外壳: IP44
- IP67(实现螺栓密封)

Technical specification:

Inserts:

- No. of contact: 7+PE
 - Rated current: 10A
 - Rated voltage: 400V
 - Rated impulse voltage: 6kV
 - Pollution degree: 3
 - Rated voltage acc.to UL/CSA: 600V
 - Insulation resistance: $>10^{10}\Omega$
 - Material: polycarbonate
 - Colour: RAL 7032(light grey)
 - Temperature range: $-40^{\circ}\text{C} - +125^{\circ}\text{C}$
 - Flammability acc.to UL 94: V0
 - Mating cycles: >500
- Contacts:
- Terminal: crimp terminal
 - Material: copper alloy
 - Surface:
 - Hard-silver plated
 - Hard-gold plated
 - Contact resistance: $<3\text{m}\Omega$
 - Wire gauge:
 - Crimp terminal: $0.14-2.5\text{mm}^2(26-14\text{ AWG})$
 - PE contact: $2.5\text{mm}^2(14\text{ AWG})$

Hoods/Housings:

- Material:
 - Plastic hoods/housings: polycarbonate
 - Metal hoods/housings: zinc die-cast
 - Flammability acc.to UL 94: V0
 - Degree of protection, acc.to IEC 60529 for coupled connector:
 - Plastic hoods/housings: IP67
 - Metal hoods/housings: IP44
- IP67(is achieved with seal screw)

		订货号 Order No.	
		产品代号 Part Code	
版本 REV	重量 weight	比例 Scale	SO-HQ-007/0-MC
V1.0	13g	1:1	



浙江思美克电气科技有限公司
ZHEJIANG SMICO ELECTRICAL TECHNOLOGY CO.,LTD